

COLLECTIVITE TERRITORIALE MARTINIQUE
COMMUNE DE SAINTE ANNE
Lieu dit " Cap Cabaret "

PA 4

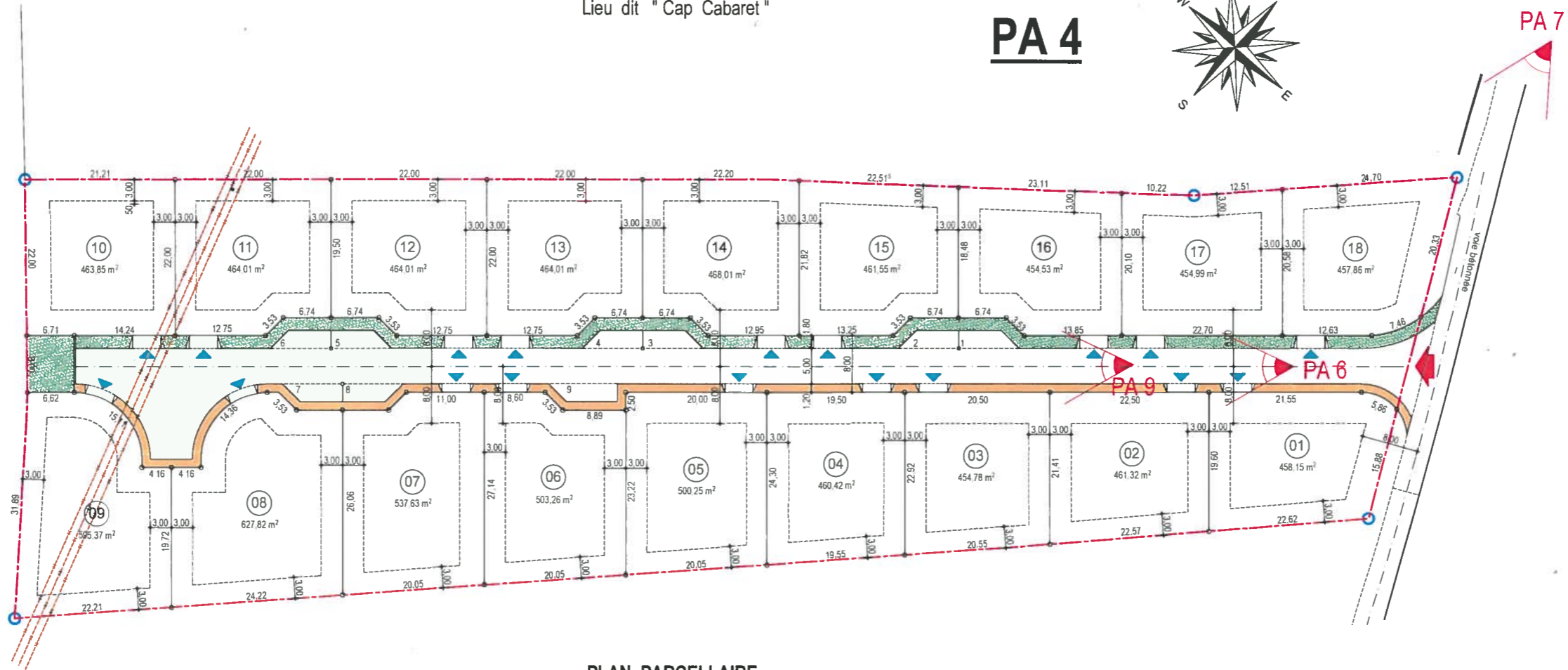
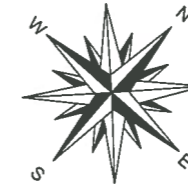

PLAN PARCELLAIRE
Echelle : 1/750e

COLLECTIVITE TERRITORIALE MARTINIQUE
COMMUNE DE SAINTE ANNE
Lieu dit " Cap Cabaret "

B 87

PA 4

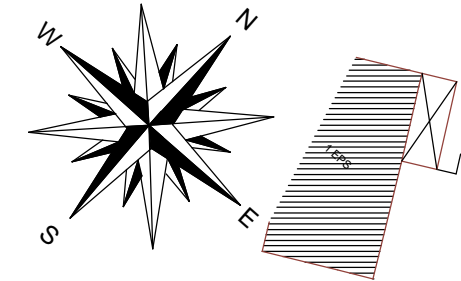

PA 7

B 87

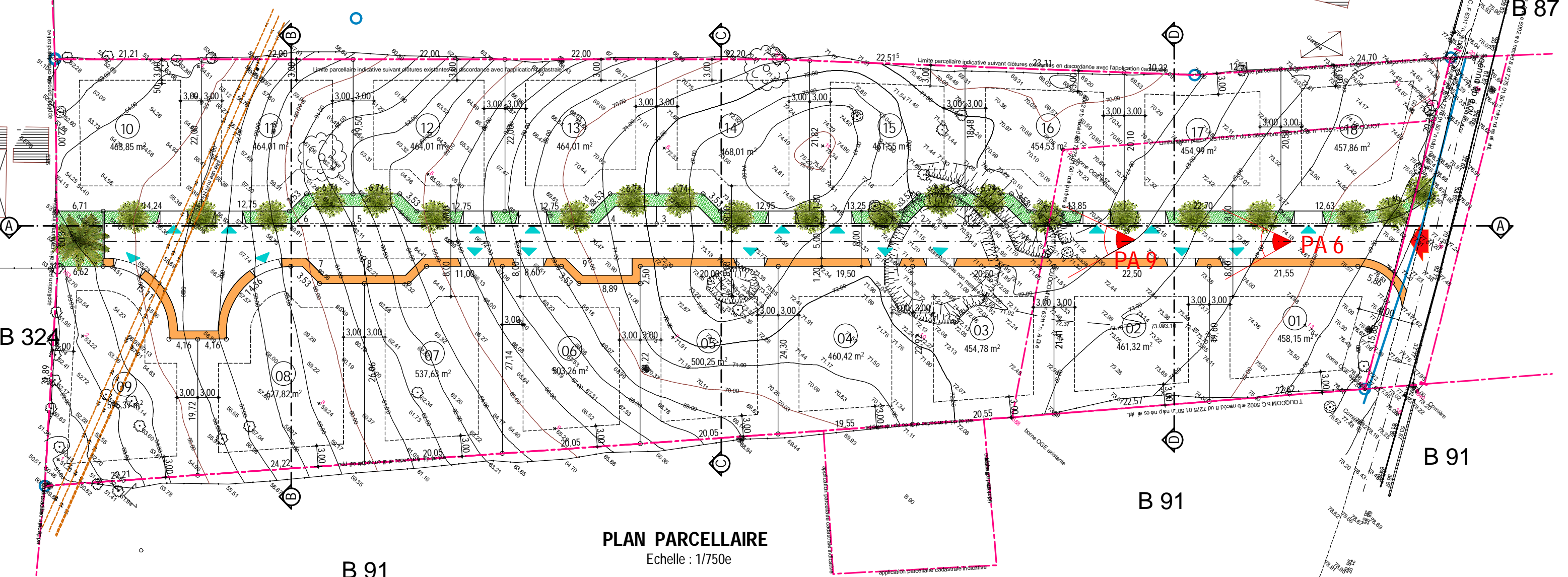

B 324

PLAN PARCELLAIRE
Echelle : 1/750e

B 91

B 91

B 91